

HUSHTONE™ HUSH BEAM™ BAFFLE

PET | POLYESTER ACOUSTICAL PRODUCTS

HUSH BEAM BAFFLE Drywall/Concrete Installation Overview

AIRCRAFT CABLE

These installation suggestions consist of a common process for baffle installation. Installers should rely upon their own professional experience and understanding of their unique requirements to ensure a successful install.

TOOLS NEEDED



Cable Cutter

OPTIONAL



1/16" Aircraft Cable
(3' per baffle included)

Additional length required, if any,
will be determined by site needs

Note: Installer to select preferred ceiling hardware.

ITEMS INCLUDED

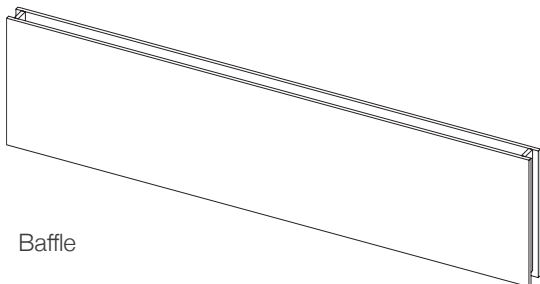

Baffle

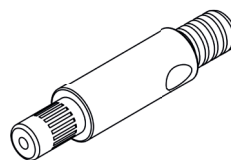

(2) Grip Lock

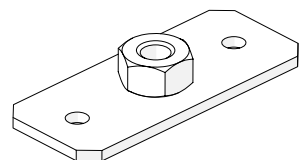

(2) Flat Brackets

HUSHTONE™ HUSH BEAM™ BAFFLE

PET | POLYESTER ACOUSTICAL PRODUCTS

HUSH BEAM BAFFLE Drywall/Concrete Installation Overview

AIRCRAFT CABLE

1. Locate where the flat bracket should be placed; to ensure the baffle hangs evenly, be sure to space them at equal distances from each end.

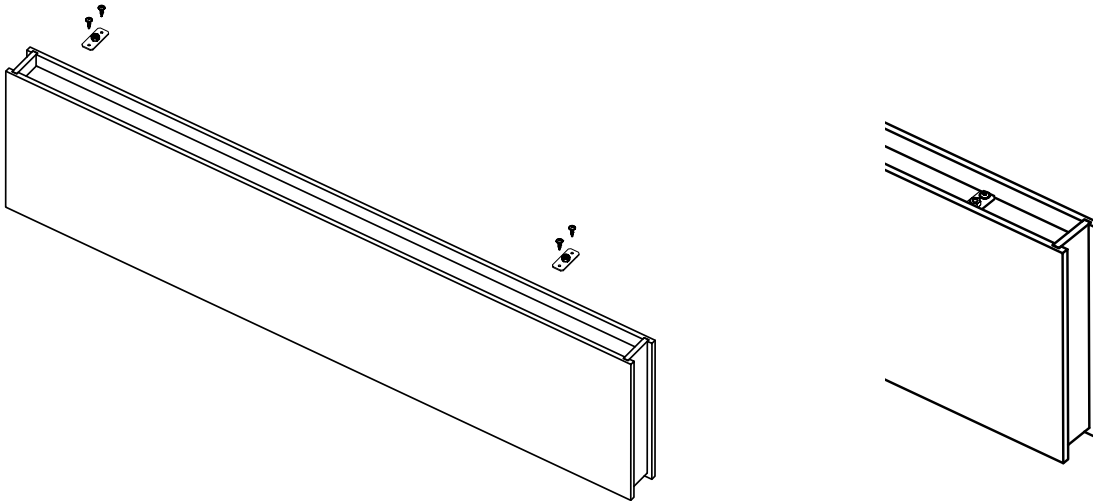

2. Insert and lock the aircraft cable into the grip lock.

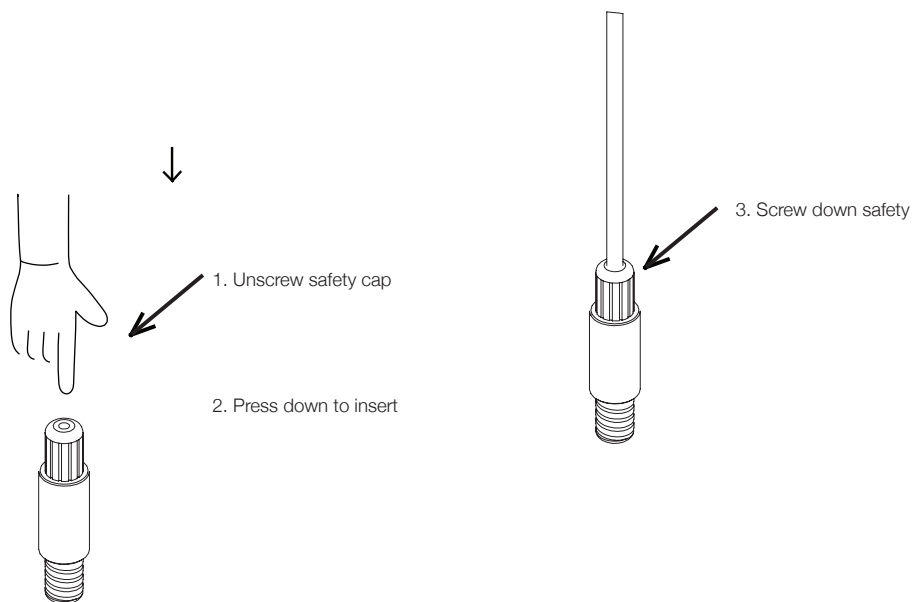

HUSHTONE™ HUSH BEAM™ BAFFLE

PET | POLYESTER ACOUSTICAL PRODUCTS

HUSH BEAM BAFFLE Drywall/Concrete Installation Overview

AIRCRAFT CABLE

3. Screw the grip lock to the bracket on the baffle.

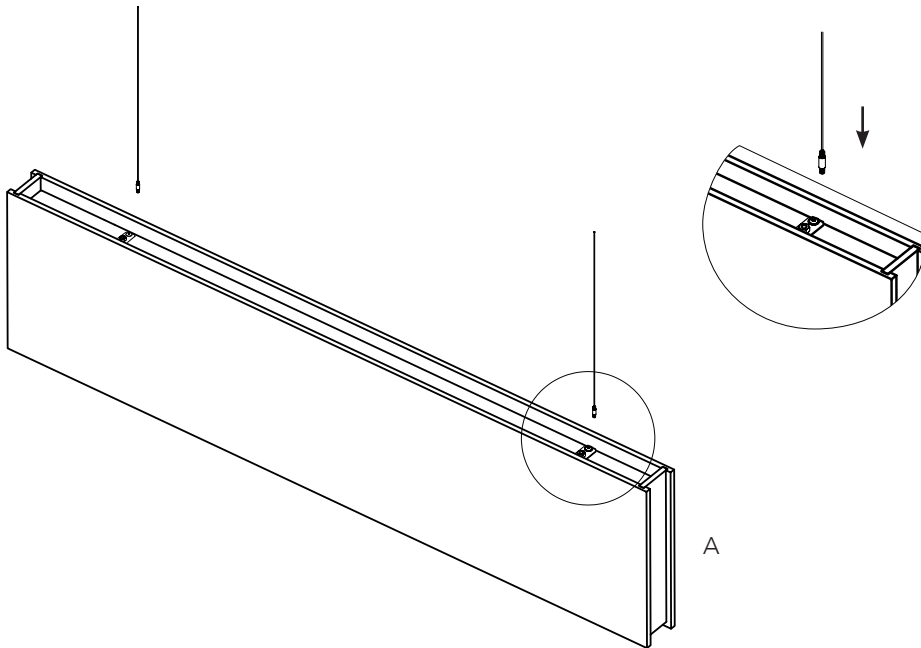

4. Complete installation.

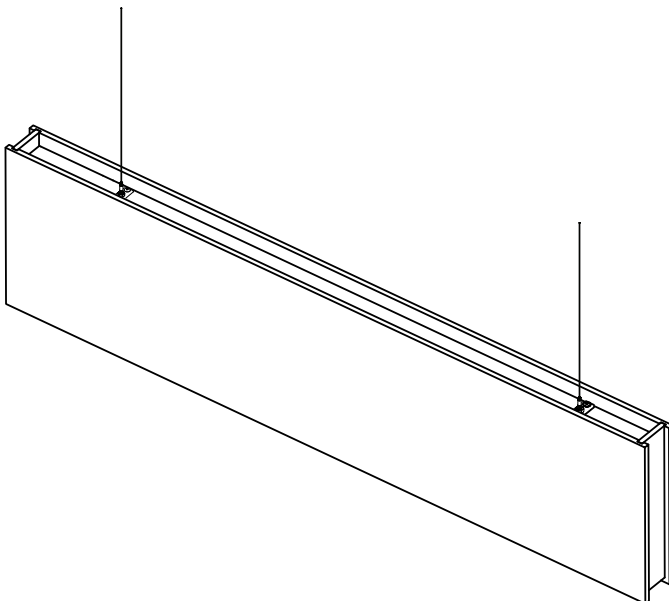

HUSHTONE™ HUSH BEAM™ BAFFLE

PET | POLYESTER ACOUSTICAL PRODUCTS

HUSH BEAM BAFFLE Drywall/Concrete Installation Overview

THREADED ROD

These installation guidelines consist of the common process of adding a 1/4" (20) threaded stud for baffle installation. Installers should rely upon their own professional experience and understanding of their unique requirements to ensure a successful installation.

TOOLS NEEDED



Cable Cutter

BY OTHERS



Threaded Rod 1/4-20

ITEMS INCLUDED

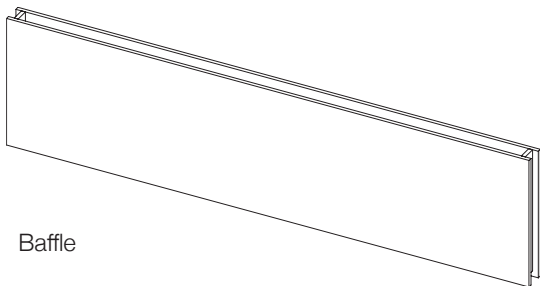

Baffle

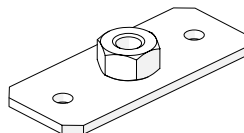

(2) Flat Brackets

HUSHTONE™ HUSH BEAM™ BAFFLE

PET | POLYESTER ACOUSTICAL PRODUCTS

HUSH BEAM BAFFLE Drywall/Concrete Installation Overview

THREADED ROD

1. Locate where flat bracket should be placed; we recommend approximately 6" from each side of the baffle.

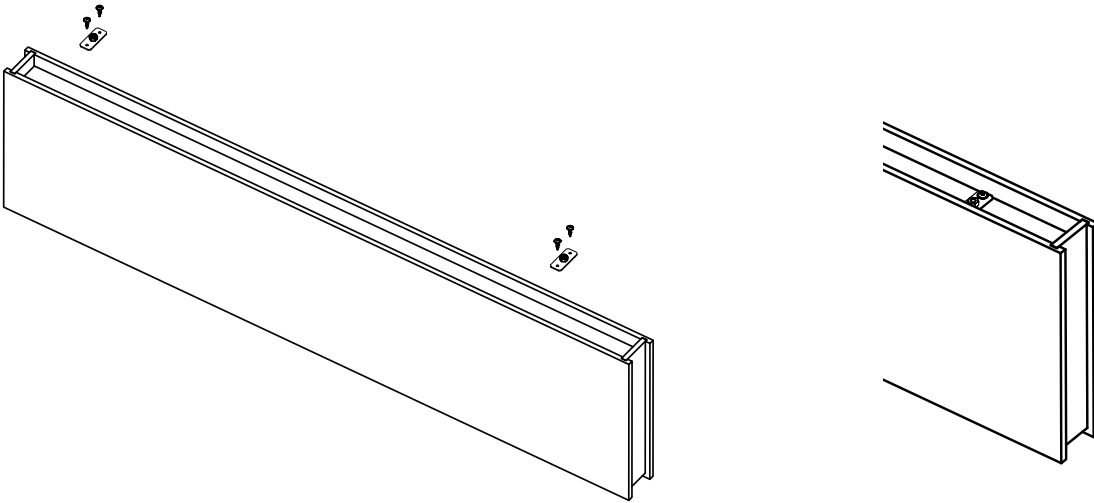

2. Install the threaded rod into the flat bracket.

